

PS 6153 - Strut Safety End Cap

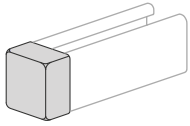

(For OSHA Req'd End of Hand Rail)

Material: Red Colored PVC

Part No.	Use With	Wt./100 pcs.
PS-6153-1	PS-100, PS200 2T3	5.0
PS-6153-2	PS-200,PS-210	2.8
PS-6153-3	PS-300	2.5
PS-6153-5	PS-500, PS-520, PS560	2.0

Project: _____

Approval Stamp:

Architect / Engineer: _____

Date: _____ **Phone:** _____

Contractor: _____

Address: _____

Notes 1: _____

Notes 2: _____
