

NEER™ Service Entrance Connectors

NEC/CEC:
Listed for Ordinary Locations

NEC/CEC:
Listed for Ordinary Locations

UF: For Underground Cable

Applications

- Gland type connector for sealing and terminating. Type UF cable.

Standard Material/Finish

- Steel/zinc plated
- Grommet: neoprene

NEC/CEC Certifications and Compliances

- UL Standard: 514B
- UL Listed: E25015
- NEMA: FB-1



UF

Illustrated Dimensions

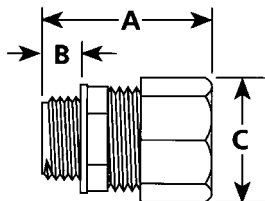

Trade Size (Inches)	Dimensions in Millimeters (Inches)			Cable Range	Catalog Number
	A	B	C		
1/2	33.3 (1.31)	12.7 (0.50)	27.4 (1.08)	14-2 and 12-2 AWG	UF-50
3/4	38.4 (1.51)	13.2 (0.52)	33.8 (1.33)	14-3, 12-3, 10-3 and 8-2 AWG	UF-75

Ⓢ Not CSA certified

* WC Note: Connector Selection: SE dimensions are based upon average dimensions given by various manufacturers of cable. Individual manufacturers vary. Actual dimensions must be checked and proper fittings selected based upon "grommet range minimum" column.

WC: For Oval SE/U Cable

Applications

- For terminating and sealing service entrance cable entering an enclosure or conduit hub.

Standard Material/Finish

- Body: zinc diecast
- Compression washer: steel/zinc plated
- Grommet: neoprene

NEC/CEC Certifications and Compliances

- WC-1004 thru WC-2004N, except WC-1501 and WC-2001
UL Listed: E37336
- WC-1004 thru WC-2004N
CSA Certified: LR14489



WC

Illustrated Dimensions

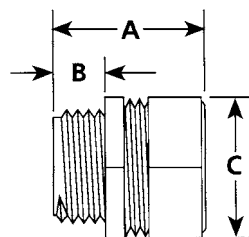

Trade Size (Inches)	Grommet ① Minimum	Opening Maximum	Dimensions in Millimeters (Inches)			Catalog Number
			A	B	C	
1	0.50 (0.32)	0.80 (0.50)	39.6 (1.56)	14.0 (0.55)	38.1 (1.50)	WC-1004
1	0.71 (0.40)	0.70 (0.44)	39.6 (1.56)	14.0 (0.55)	38.1 (1.50)	WC-1006
1	0.81 (0.44)	0.63 (0.40)	39.6 (1.56)	14.0 (0.55)	38.1 (1.50)	WC-1008
1-1/4	0.93 (0.51)	0.85 (0.57)	50.5 (1.99)	15.5 (0.61)	46.7 (1.84)	WC-1252
1-1/4	0.87 (0.48)	0.85 (0.51)	50.5 (1.99)	15.5 (0.61)	46.7 (1.84)	WC-1253
1-1/4	1.05 (0.57)	0.94 (0.66)	50.5 (1.99)	15.5 (0.61)	46.7 (1.84)	WC-1252N
1-1/2	1.10 (0.65)	1.19 (0.70)	55.4 (2.18)	15.7 (0.62)	54.6 (2.15)	WC-1501
1-1/2	1.20 (0.70)	1.23 (0.74)	55.4 (2.18)	15.7 (0.62)	54.6 (2.15)	WC-1502
2	1.10 (0.65)	1.19 (0.70)	61.2 (2.41)	19.3 (0.76)	65.3 (2.57)	WC-2001
2	1.20 (0.70)	1.23 (0.74)	61.2 (2.41)	19.3 (0.76)	65.3 (2.57)	WC-2002
2	1.30 (0.75)	1.41 (0.83)	61.2 (2.41)	19.3 (0.76)	65.3 (2.57)	WC-2003
2	1.43 (0.84)	1.53 (0.89)	61.2 (2.41)	19.3 (0.76)	65.3 (2.57)	WC-2004
2	1.58 (0.94)	1.58 (1.00)	61.2 (2.41)	19.3 (0.76)	65.3 (2.57)	WC-2004N