

Molded PVC Couplings

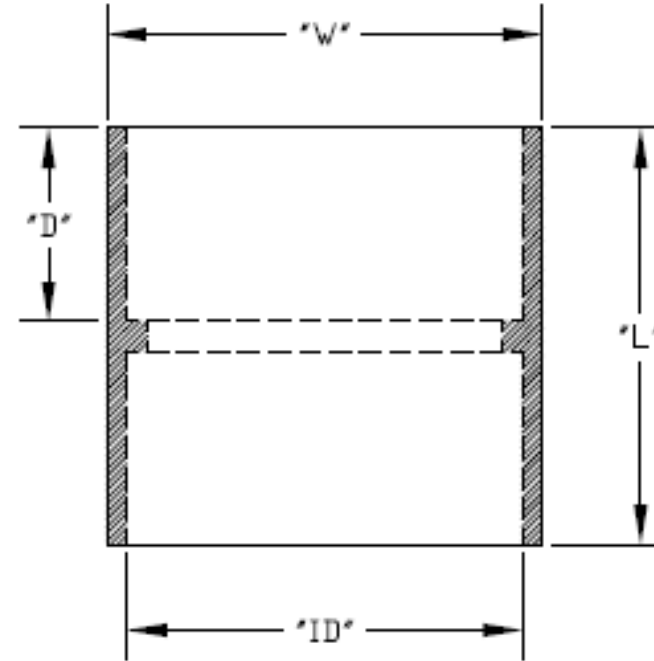

Conform to **UL 651** and **NEMA TC 3**

Part Number	Trade Size	I.D. at Entrance	D - min	L - min (REF)	W (REF)
59601	1/2"	0.852	0.652	1.398	1.042
59602	3/4"	1.064	0.719	1.532	1.254
59603	1"	1.330	0.875	1.844	1.530
59604	1-1/4"	1.677	0.938	1.970	1.917
59605	1-1/2"	1.918	1.062	2.218	2.158
59606	2"	2.393	1.125	2.344	2.653
59607	2-1/2"	2.890	1.469	3.126	3.220
59608	3"	3.515	1.594	3.376	3.947
59609	3-1/2"	4.015	1.687	3.562	4.467
59610	4"	4.515	1.750	3.688	4.989
59611	5"	5.593	1.937	4.062	6.109
59612	6"	6.658	2.125	4.500	7.218



UL651 and NEMA TC-3 dimensional tolerances apply

